

The background of the image is a grayscale photograph of architectural blueprints spread out on a surface. Several large, light-colored, cylindrical tubes are rolled up and placed diagonally across the blueprints. The tubes are positioned in the foreground, partially obscuring the technical drawings. The blueprints themselves show various lines, circles, and text, typical of engineering or construction plans. The overall lighting is soft, creating a professional and technical atmosphere.

# Construction Details

## Free Standing Masonry Walls

A discussion by  
**Ron Koudys**









































**BISHOP HELLMUTH HERITAGE DISTRICT**





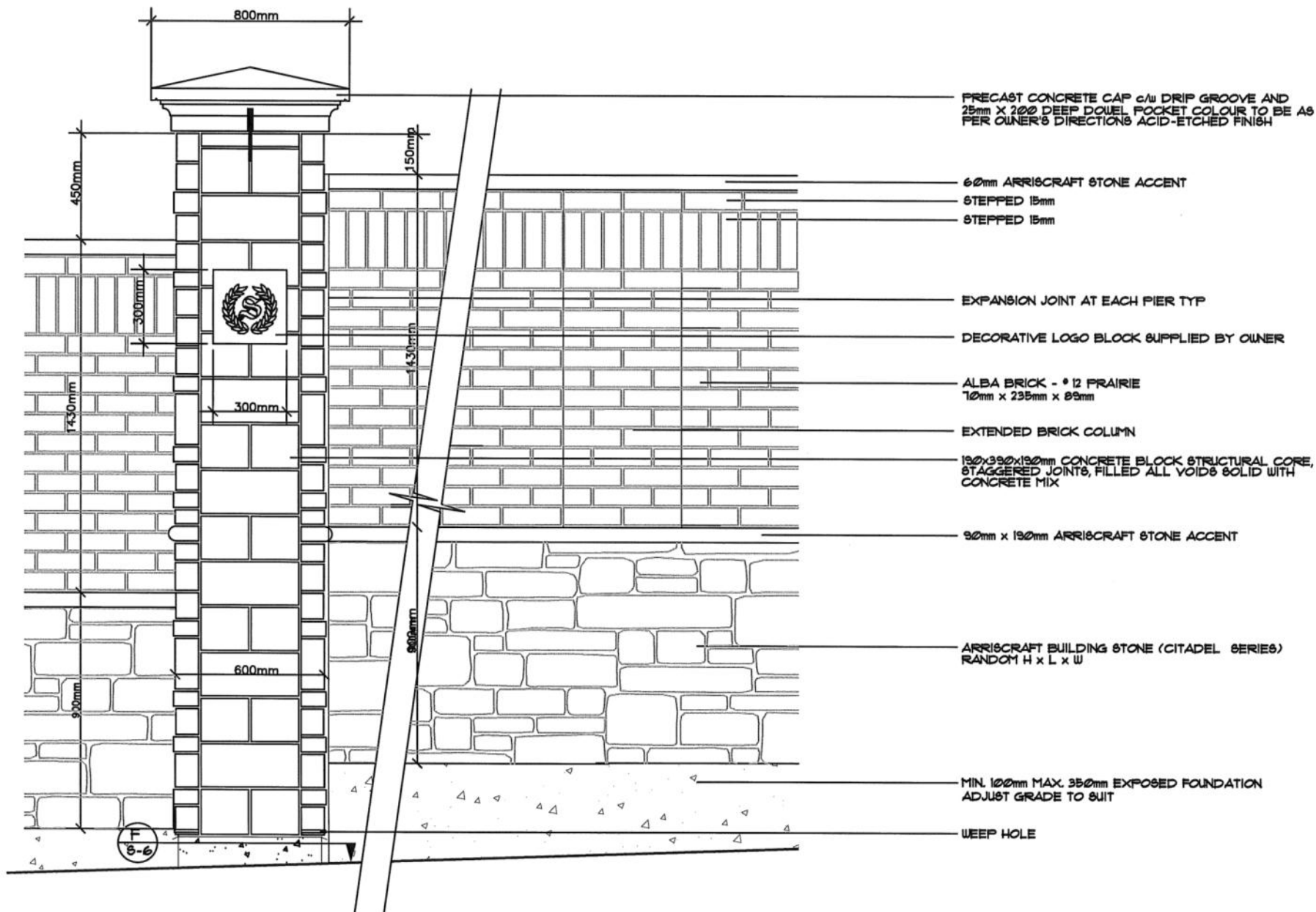



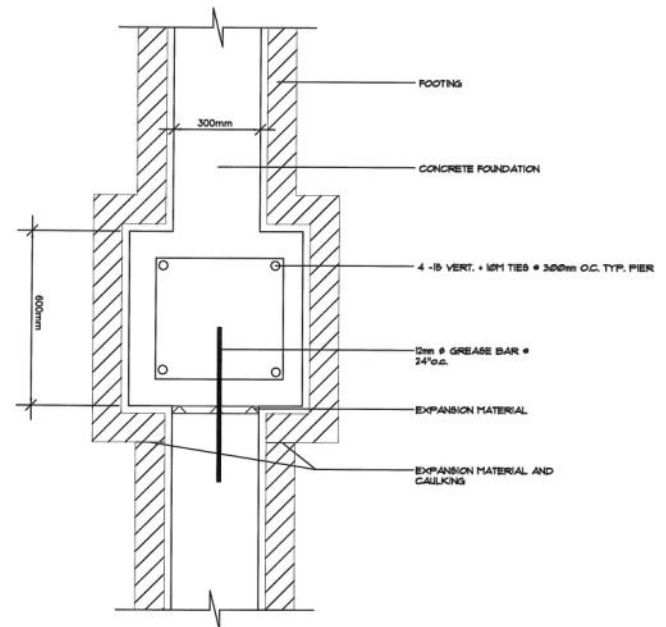
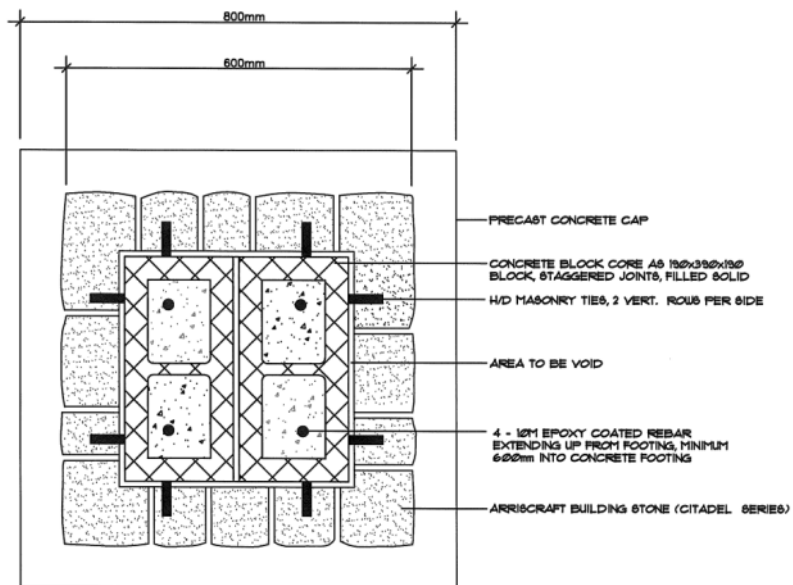
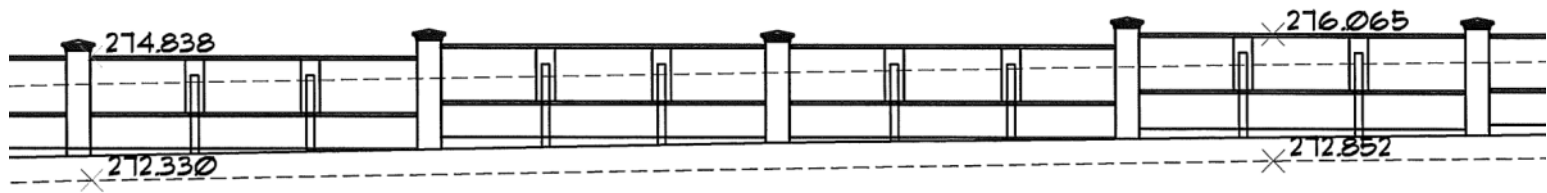

NOTES:

1. EXPANSION JOINTS OCCUR ON ONE SIDE OF A PIER AT SUBMIT TYP

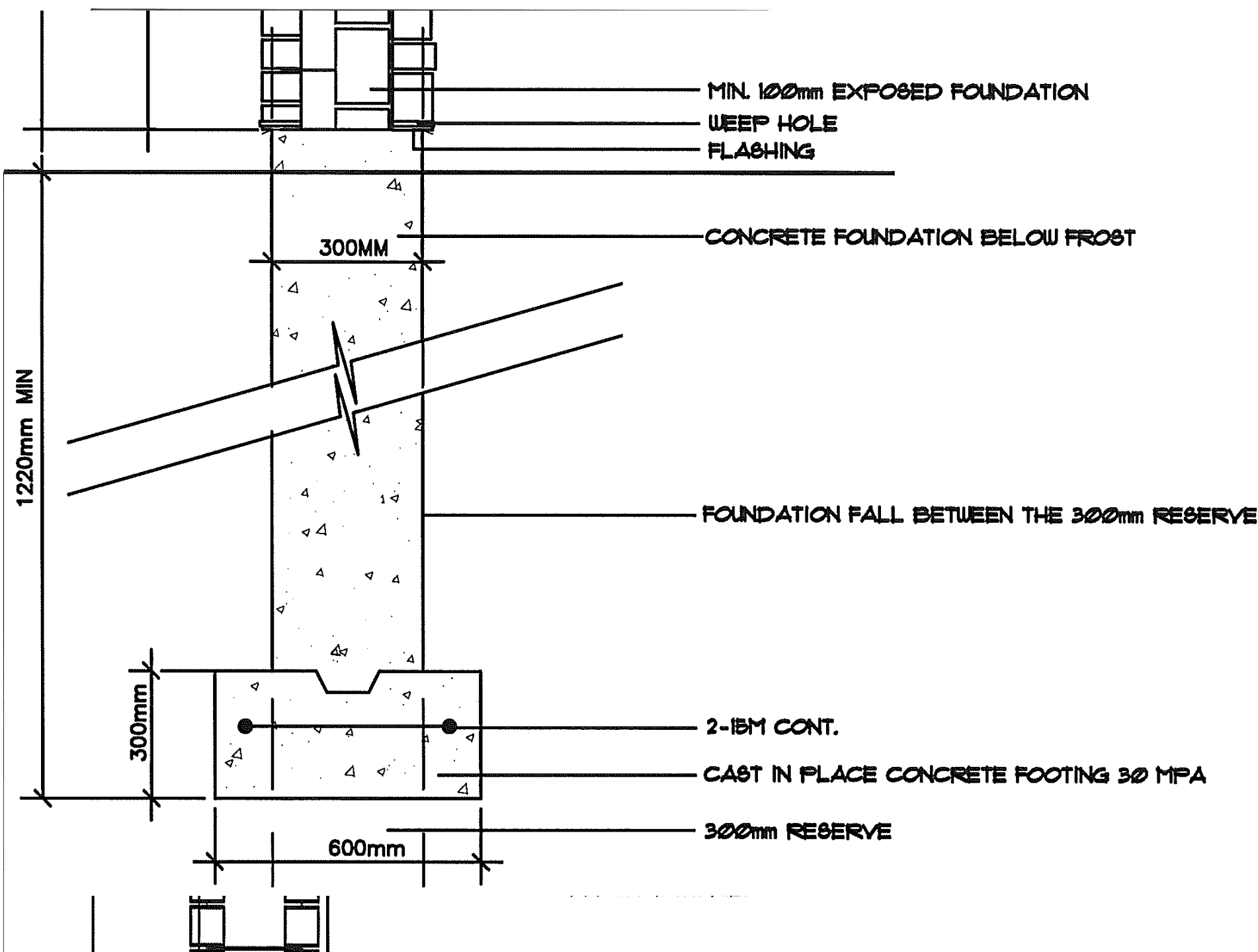



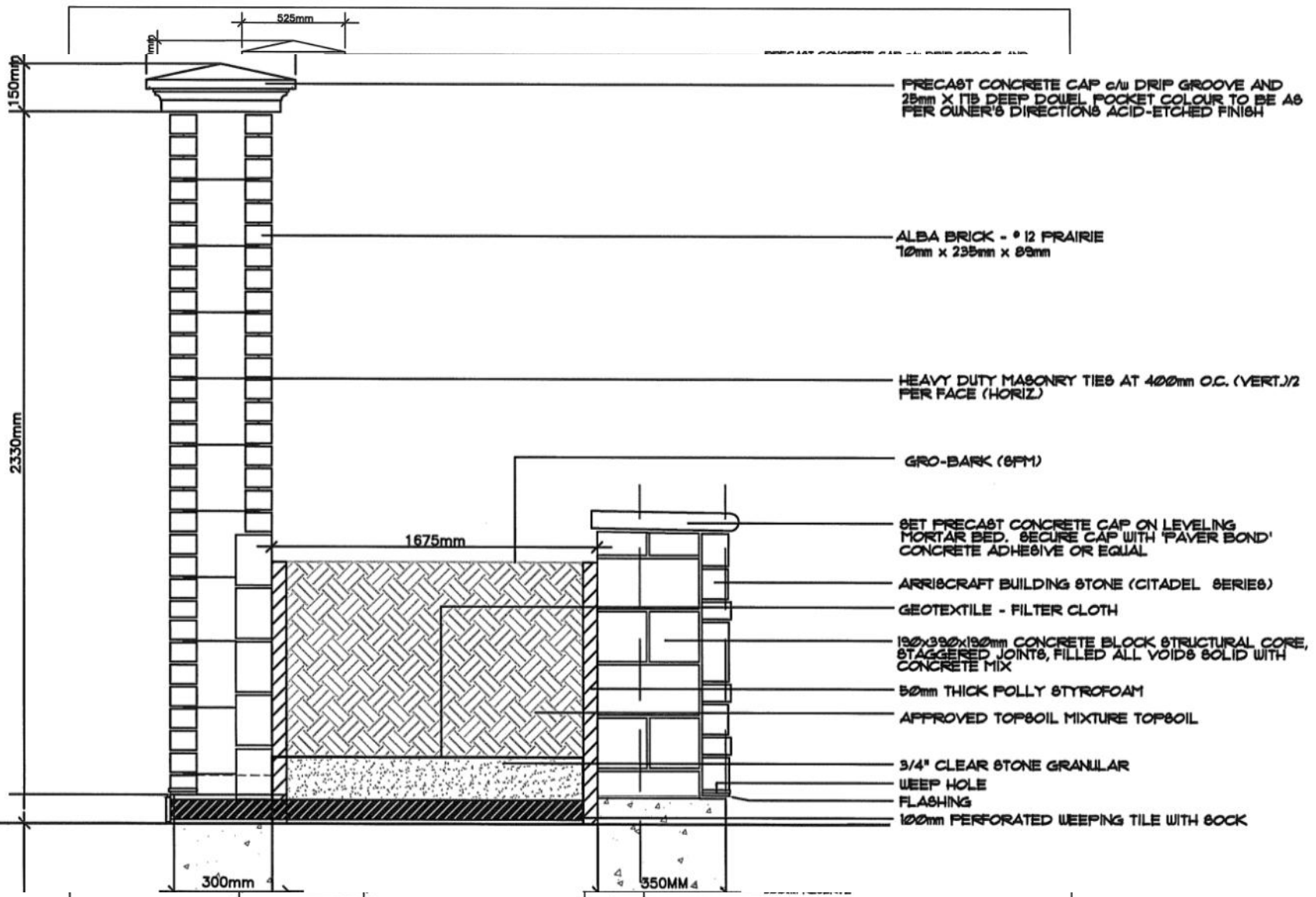

B  
S-2

SOUND WALL PLANTER DETAIL  
PLANTER SECTION

N.T.S.

3050mm MAX.

HEIGHT WILL VARY DEPENDING ON GRADE

900mm

260mm

D  
S-4

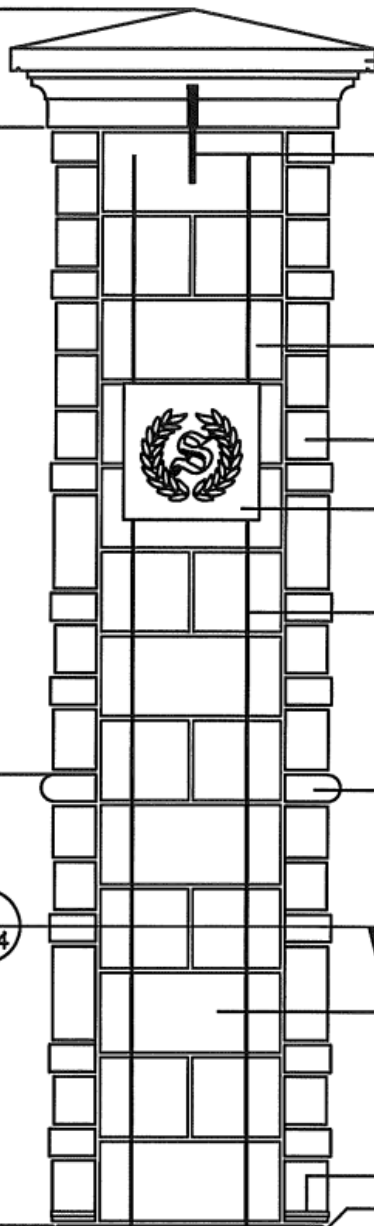

PRECAST CONCRETE CAP c/w DRIP GROOVE AND 25mm X 200 DEEP DOWEL POCKET COLOUR TO BE AS PER OWNER'S DIRECTIONS ACID-ETCHED FINISH

15M EPOXY COATED DOWEL, 250 LONG, CAST INTO BLOCK CORE AND EPOXY EXTENDING 100mm ABOVE CORE. ALIGN WITH DOWEL POCKET IN CAP.

300mm x 300mm DECORATIVE STONE LOGO

ARRISCRAFT BUILDING STONE (CITADEL SERIES)

DECORATIVE LOGO BLOCK SUPPLIED BY OWNER

4-10M + FILL VOIDS SOLID

90mm x 190mm ARRISCRAFT STONE ACCENT

190x390x190mm CONCRETE BLOCK STRUCTURAL CORE, STAGGERED JOINTS, FILLED ALL VOIDS SOLID WITH CONCRETE MIX

WEEP HOLE

FLASHING

MIN. 100mm EXPOSED FOUNDATION

CONCRETE FOUNDATION BELOW FROST















